



BLANKE

# SURFACE HEATING AND COOLING SYSTEMS

WATER-BASED SYSTEM

Highly efficient heating with smart home solutions

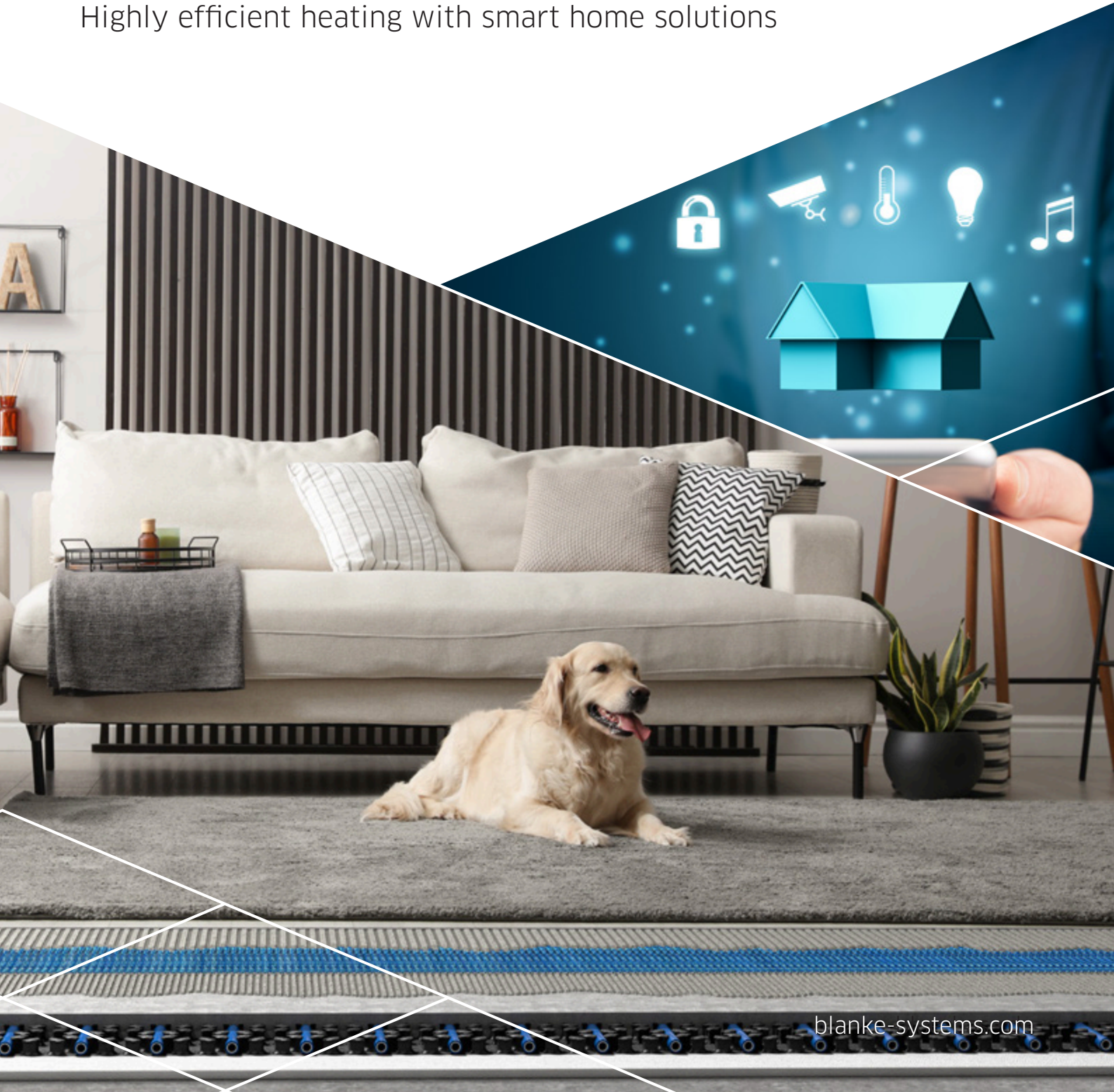

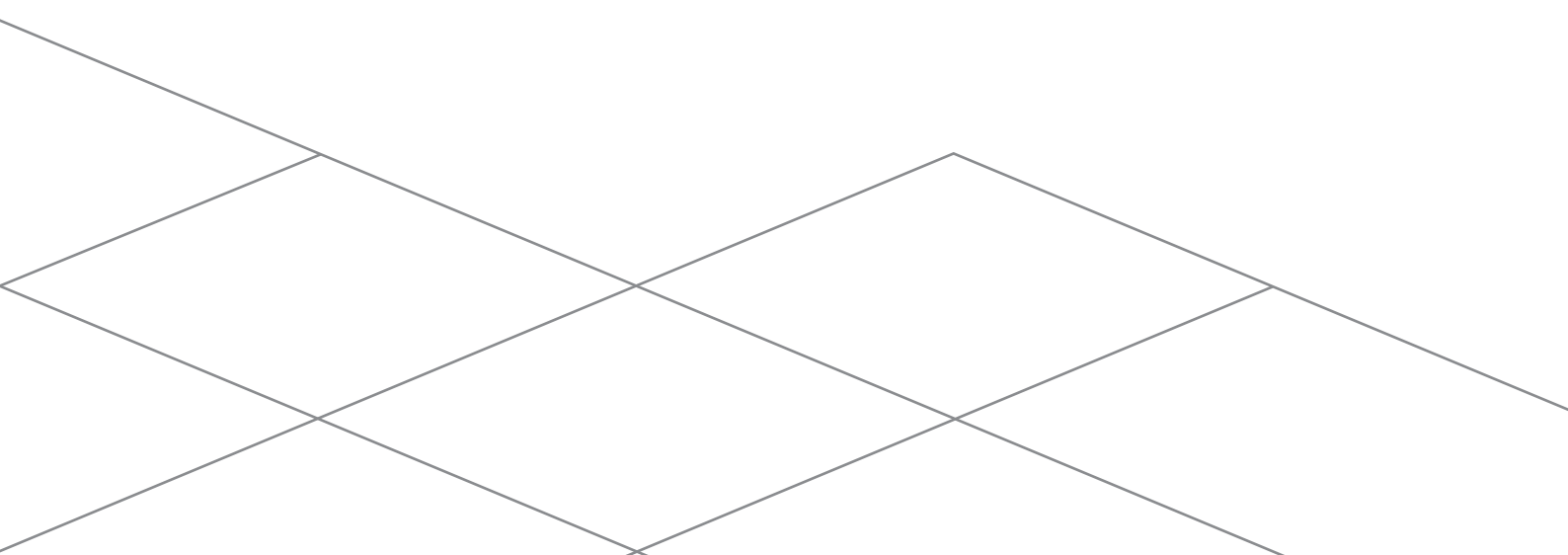



## CONTENT

BLANKE PERMATOP SF	4
BLANKE PERMATOP BF, BF+, BFC	8
BLANKE PERMATOP BF	9
BLANKE PERMATOP BF+	10
BLANKE PERMATOP BFC	11
BLANKE FLATBASE and accessories	12
BLANKE PERMATOP 1000/3000/ECO	14
BLANKE PERMATOP 1000	15
BLANKE PERMATOP 3000	16
BLANKE PERMATOP ECO	17
BLANKE PERMATOP WOOD/NATURE	20
BLANKE PERMATOP WOOD	21
BLANKE PERMATOP NATURE	22
BLANKE PERMATOP WALL	24
ACCESSORIES and TOOLS	26
BLANKE HEATING CIRCUIT MANIFOLDS AND CONTROL TECHNOLOGY	28
BLANKE VARIO HEATING CIRCUIT MANIFOLD	29
BLANKE CONTROL 230	32



## BLANKE PERMATOP SF

Modular, thin layer underfloor heating and cooling system for tiles and natural stone coverings

All systems from the BLANKE PERMATOP series can be perfectly combined with Blanke's control system and smart home solutions.

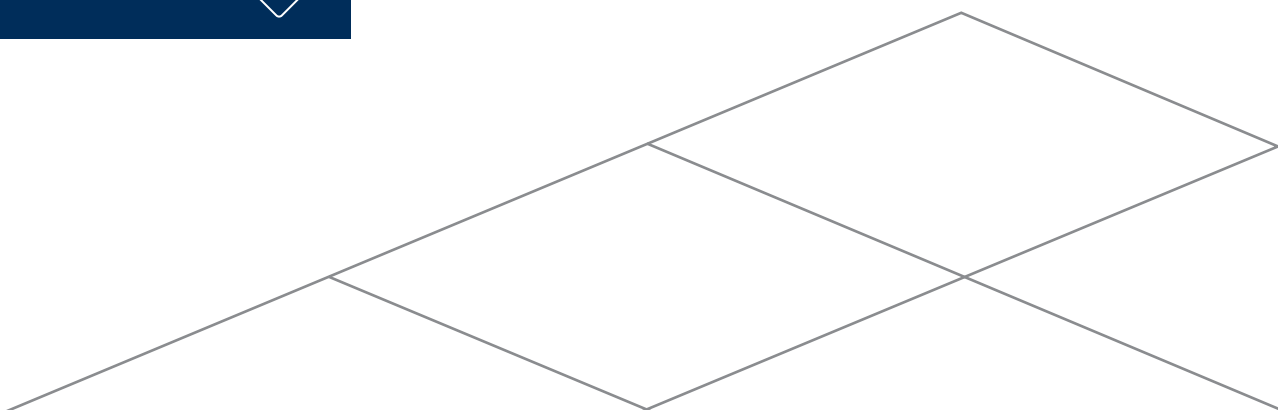

## BLANKE PERMATOP SF

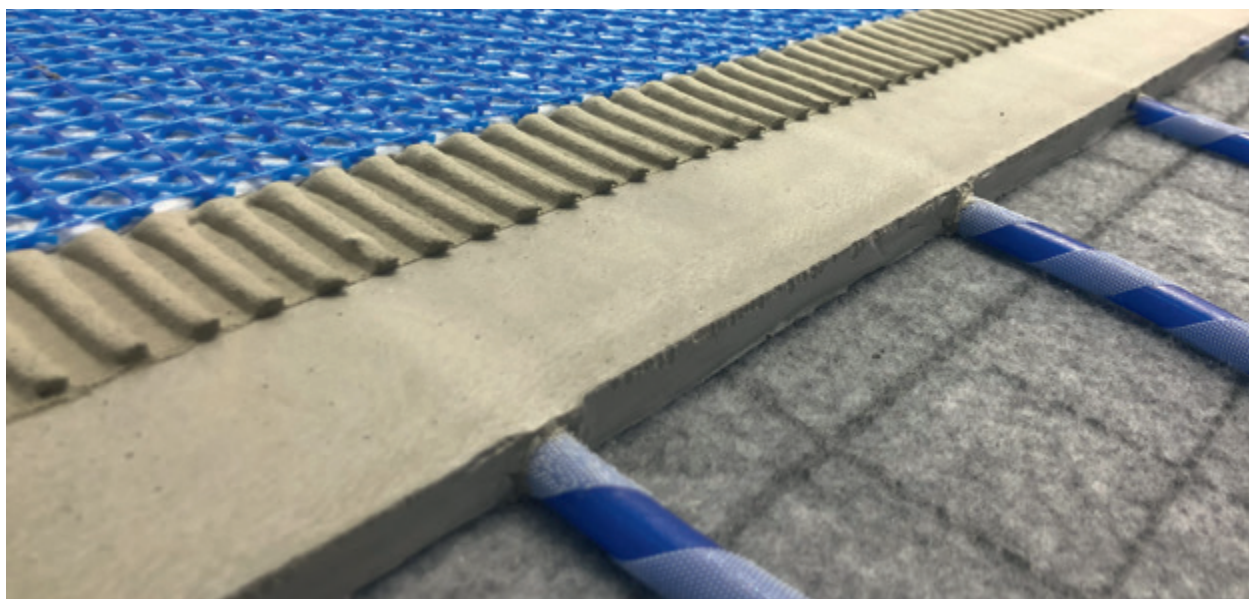

---

### ADVANTAGES AT A GLANCE

---

- > Renovating system, is installed on an existing covering
- > Low weight and minimal installation height of just 12 mm\*
- > Fast reacting in heating and cooling mode
- > Quick installation with zero waiting time
- > Easy levelling thanks to the integrated energy distribution layer BLANKE SF FILLER

BLANKE PERMATOP SF for tile and stone floor coverings is a surface heating and cooling system. The system consists of a self-levelling energy distribution layer with integrated heating and cooling conductors. This consists of a high-quality PE heating pipe with velcro technology which makes it extremely easy to install on the self-adhesive fabric mat. The velcro technology provides for an especially simple installation and no individual planning is required in advance. PERMATOP SF is perfectly rounded off by the BLANKE PERMAT, which has proven itself over many years as a reinforcing underlayment and decoupling mat.

The extremely low installation height of just 12 mm\* makes BLANKE PERMATOP SF particularly suitable for renovations. The system is installed on top of the existing flooring, so that no extra costs are incurred for removing the old floor structure during the renovation. In addition, the interior spaces are not contaminated by dirt or noise. In combination with the self-levelling energy distribution layer BLANKE PERMATOP SF FILLER, this enormously reduces the construction time. The filler can be walked on after just 3 hours and the floor-laying work can be carried out straight away. Benefit for building clients: The property does not have to be vacated during the renovation.

All individual components of the PERMATOP SF series are technically coordinated with each other and, due to their material properties, form a guaranteeable overall heating and cooling system. The warmth generated by the system can be felt particularly quickly as the heating conductors lie close to the floor covering due to the low installation height.

\* Note: 14 mm top edge SF filler without PERMAT for soft coverings  
12 mm top edge SF filler without PERMAT for ceramic coverings

## CONSTRUCTION

- 1 Wall with plaster
- 2 BLANKE RDS 5/50
- 3 Existing load-bearing floor/ceiling construction
- 4 Tile
- 5 Thin-bed mortar C2/S1
- 6 BLANKE PERMAT
- 7 Thin-bed mortar C2/S1
- 8 BLANKE SF FILLER\*
- 9 BLANKE SF KLETT-TEC PE-RT 10 x 1.3 mm
- 10 BLANKE SF BASE

\*1 mm pipe covering



Reg. no.: 7F500-F

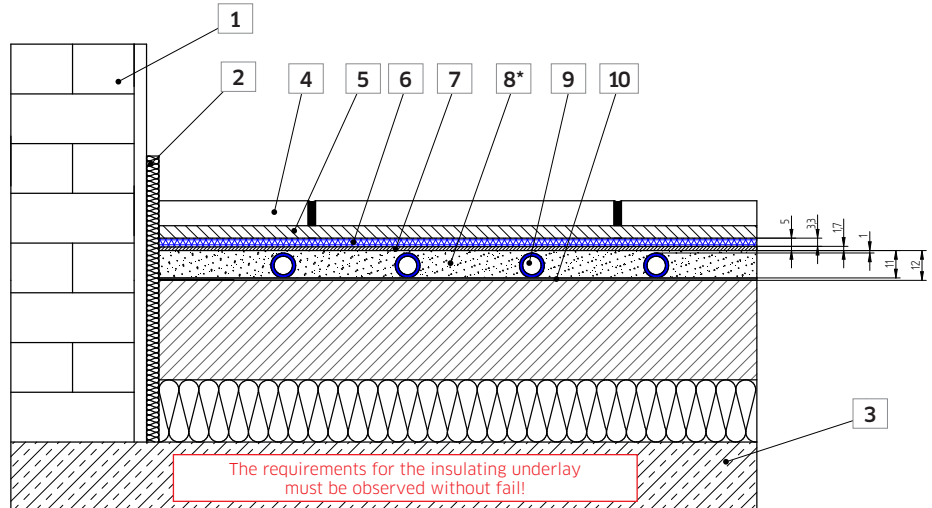

## BLANKE PERMATOP SF COMPONENTS

- 1 Blanke SF BASE
- 2 BLANKE RDS 5/50
- 3 BLANKE SF KLETT-TEC
- 4 BLANKE BENDS 10
- 5 BLANKE SF FILLER
- 6 BLANKE PERMAT
- 7 BLANKE SF COMPRESSION FITTING
- 8 BLANKE COUPLING

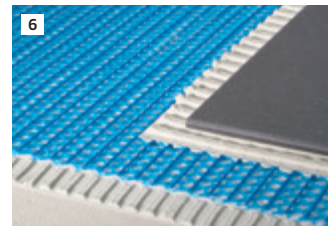
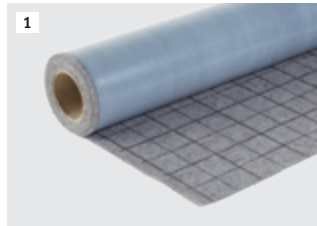





## BLANKE PERMATOP BF, BF+, BFC

Underfloor heating and cooling systems -  
quick and easy installation

All systems from the BLANKE PERMATOP series can be  
perfectly combined with Blanke's control system and  
smart home solutions.

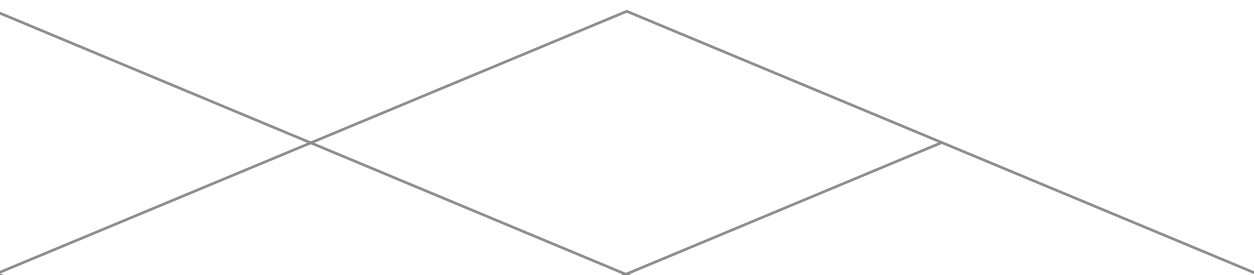



## BLANKE PERMATOP BF



### ADVANTAGES AT A GLANCE

- > Unevenness of the screed is prevented by the special circular geometry of the studded plate for controlled stress relief
- > System heating pipe with internal EVOH barrier layer for maximum safety
- > Saving of three to five weeks installation time on tile/stone floor surface coverings
- > 5-year warranty against cupping and cracks in ceramic floor coverings

The BLANKE PERMATOP BF solution was developed as a thin-layer surface heating and cooling system. This is a complete system that can be installed with screeds commonly used on construction sites. The system consists of a polystyrene studded panel which allows controlled shrinkage of the screed due to the special circular geometry of the system panel.

The predetermined stress relief of the shrinkage stress in the screed means that this system design is practically free of cupping.

The heating pipe with a diameter of either 14 or 16 mm is made of polyethylene (PE-RT) with an EVOH oxygen barrier layer. This protects the 5-layer pipe against damage during the installation.

The system is completed by the BLANKE PERMAT underlayment which perfectly protects the floor surface covering against stress cracks and high loads. Due to the special design, with tile/stone floor surface coverings the drying time for the screed and the heating protocol become superfluous, which saves several weeks.

The BLANKE PERMATOP BF system has been tested and certified by the University of Stuttgart.

The system components and other accessories for BLANKE PERMATOP BF can be found starting on p. 10

### CONSTRUCTION

- 1 Wall with plaster
- 2 BLANKE RDS 10/120
- 3 Existing load-bearing floor/ceiling construction
- 4 Tile
- 5 Thin-bed mortar C2/S1
- 6 BLANKE PERMAT
- 7 Thin-bed mortar C2/S1
- 8 Screed CT-C25-F4
- 9 BLANKE BF BASE studded panel
- 10 BLANKE PIPE 14/16 heating and cooling conductors  
PE-RT 16x2mm/14x2mm

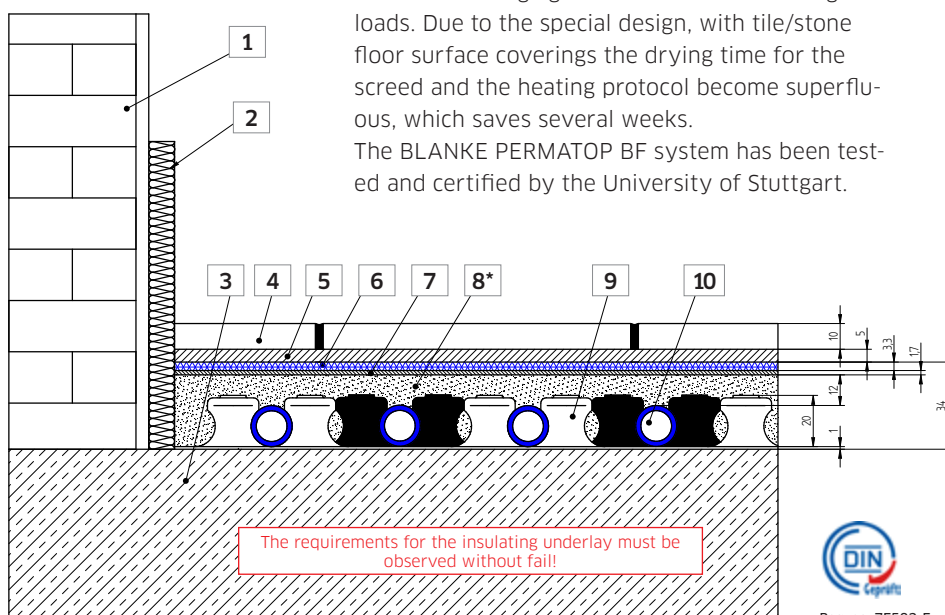

Reg. no. 7F502-F

\* Studded coverage min. 8 mm, max. 25 mm;  
with soft coverings min. 15 mm, max. 25 mm

## BLANKE PERMATOP BF+

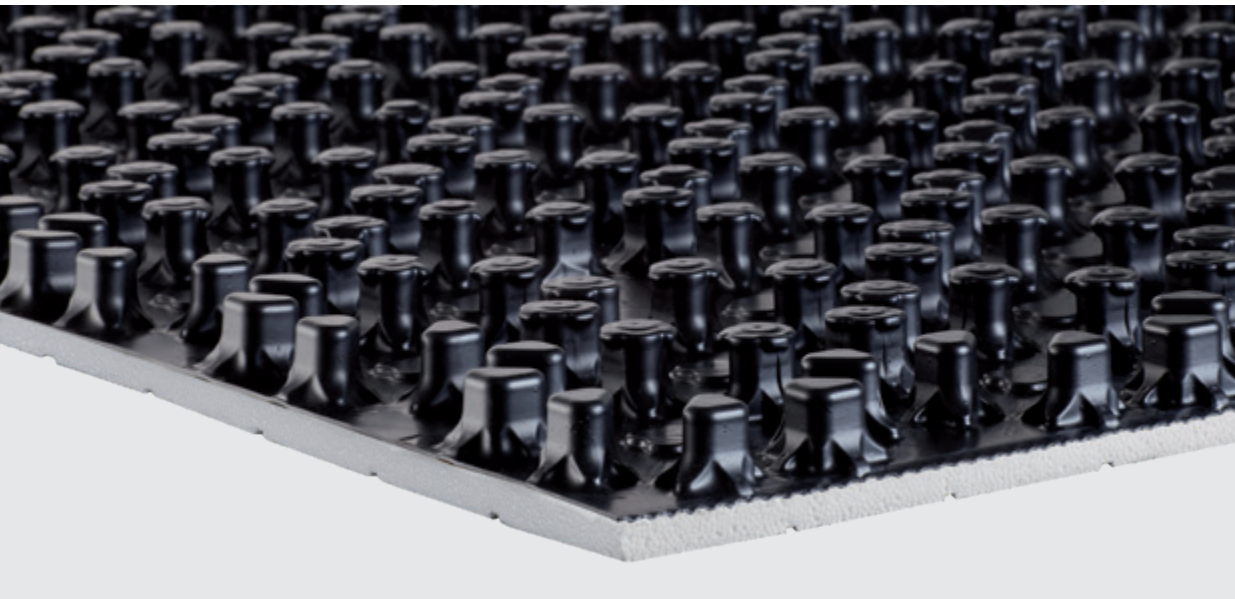

### ADVANTAGES AT A GLANCE

- > Unevenness of the screed is prevented by the special circular geometry of the studded plate for controlled stress relief
- > System heating pipe with internal EVOH barrier layer for maximum safety
- > Saving of three to five weeks installation time on tile/stone floor surface coverings
- > 5-year warranty against cupping and cracks in ceramic floor coverings
- > Integrated insulation layer (10 mm) with WLS 035

The BLANKE PERMATOP BF+ surface heating and cooling system is an advanced development of the BLANKE PERMATOP BF system series. In addition to the advantages of PERMATOP BF (page 9), the BLANKE PERMATOP BF+ system features integrated thermal insulation (WLS 035). Its low installation height of just 31 mm makes it suitable for creating an ideal combination with other insulation materials as a substrate. The foamed studded panel means that the system is particularly pressure-resistant and can be walked on during the installation without any additional protective measures.

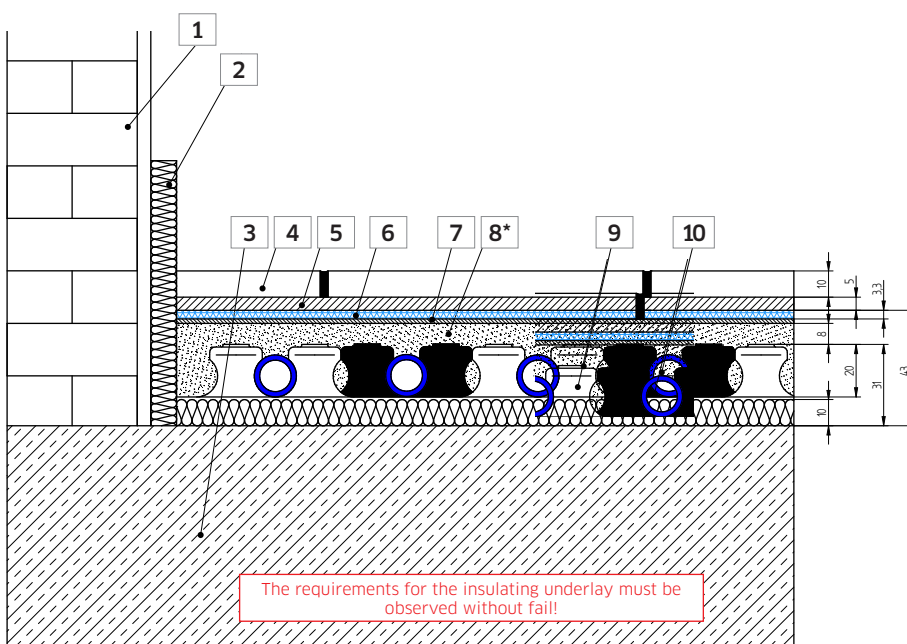

### CONSTRUCTION

- 1 Wall with plaster
- 2 BLANKE RDS 10/120 or 10/120 SK
- 3 Existing load-bearing floor/ceiling construction
- 4 Tile
- 5 Thin-bed mortar C2/S1
- 6 BLANKE PERMAT
- 7 Thin-bed mortar C2/S1
- 8 screed CT-C25-F4, CA-C25-F4 or BLANKE FILLOTHERM\*
- 9 BLANKE BF+ BASE studded panel
- 10 BLANKE PIPE 14/16 heating and cooling conductors PE-RT 16x2mm/14x2mm

\* Studded coverage min. 8 mm, max. 25 mm;  
with soft coverings min. 15 mm, max. 25 mm

## BLANKE PERMATOP BFC



### ADVANTAGES AT A GLANCE

- > Unevenness of the screed is prevented by the special circular geometry of the studded plate for controlled stress relief
- > System heating pipe with internal EVOH barrier layer for maximum safety
- > Saving of three to five weeks installation time on tile/stone floor surface coverings
- > 5-year warranty against cupping and cracks in ceramic floor coverings
- > Combined thermal and footfall sound insulation (30 mm with WLS 040 for reducing footfall sound by up to 28 dB

The BLANKE PERMATOP BFC surface heating and cooling system is an advanced development/ expansion of the BLANKE PERMATOP BF system series. In addition to the advantages of PERMATOP BF (page 9), it is characterised by the combined impact sound and thermal insulation with which the footfall sound can be reduced by up to 28 dB. The integrated thermal insulation with WLS 040 meets the minimum requirements in accordance with the standard for thermal insulation to other rooms of  $R=0.75 \text{ m}^2\text{k/W}$  and is reliably fulfilled by the system.

The system with its installation height of 59 mm does not require an additional insulation board. The design allows for maximum efficient usage of the warmth generated in the room without any energy loss to adjacent parts of the building. The system studded plate is foamed here and offers especially high pressure stability. It can be walked on during the installation without any additional protective measures.

### CONSTRUCTION

- 1 Wall with plaster
- 2 BLANKE RDS 10/120 or 10/120 SK
- 3 Existing load-bearing floor/ ceiling construction
- 4 Tile
- 5 Thin-bed mortar C2/S1
- 6 BLANKE PERMAT
- 7 Thin-bed mortar C2/S1
- 8 Screed CT-C25-F4 or CA-C25-F4\*
- 9 BLANKE BF BASE studded panel
- 10 BLANKE PIPE 14/16 heating and cooling conductors PE-RT 16x2mm/14x2mm

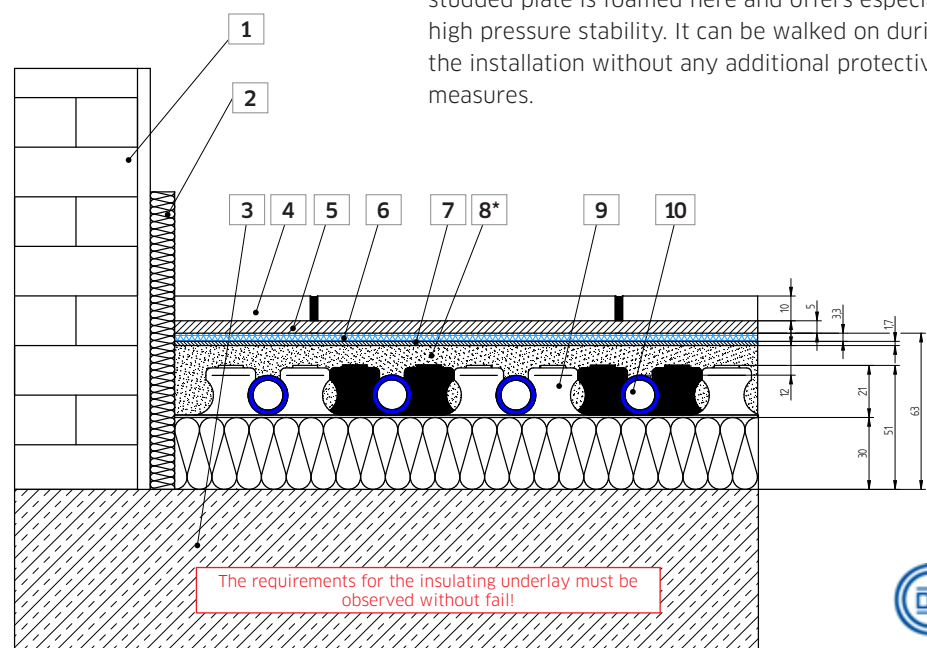

\* Studded coverage min. 8 mm, max. 25 mm; with soft coverings min. 15 mm, max. 25 mm

## BLANKE FLATBASE AND ACCESSORIES

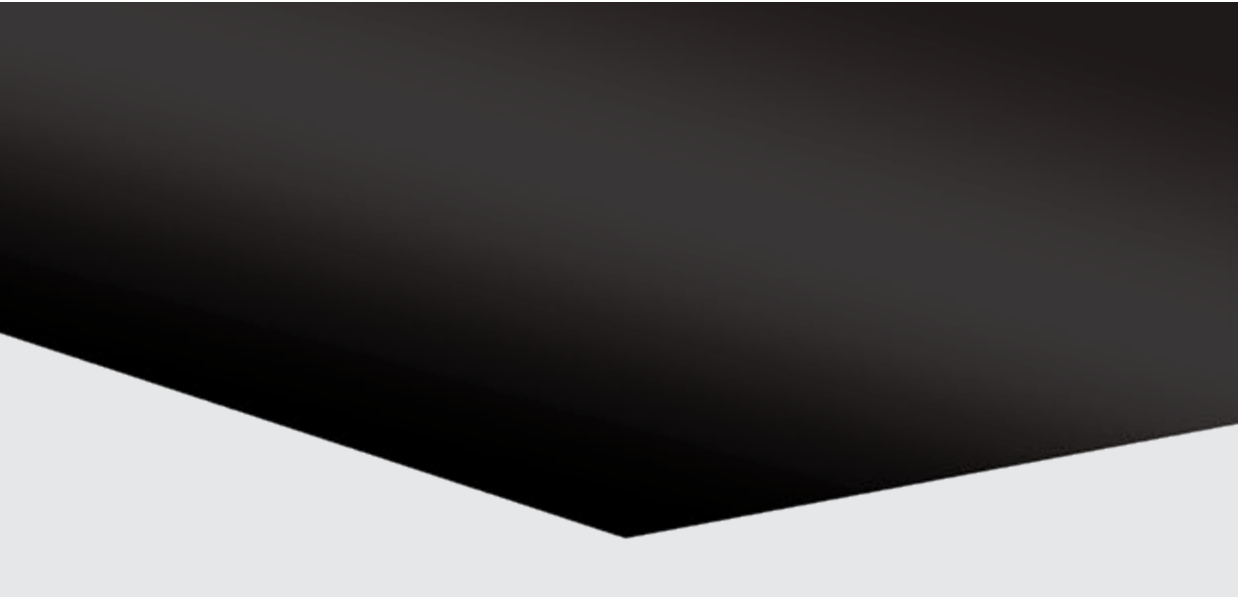

### ADVANTAGES AT A GLANCE

- > Allows individual routing of the heating pipes BLANKE PIPE 14 or 16 to the heating circuit manifold
- > Provides for the required height compensation in combination with a BLANKE DP 10 or DP 30 insulation board
- > Compatible with BLANKE PERMATOP BF, BF+ and BFC

BLANKE FLATBASE is a smooth connection panel for the area in front of the heating circuit manifold; this makes it possible to route individual BLANKE PIPE 14 or 16 to the heating circuit manifold with the aid of self-adhesive BLANKE PIPE CLIPS. Suitable pressure-resistant BLANKE DP EPS panels are available in heights of 10 mm (BF+) and 30 mm (BFC), to facilitate installing the smooth manifold connection panel next to BLANKE PERMATOP BF as well as to use it with BF+ and BFC panels. BLANKE PERMATOP BF, BF+ and BFC BASE are affixed to the BLANKE FLATBASE using double-sided adhesive tape BLANKE SK TAPE.

### BLANKE PERMATOP BF, BF+ AND BFC COMPONENTS

- 1 BLANKE FLATBASE
- 2 BLANKE SK TAPE
- 3 BLANKE DP 10
- 4 BLANKE DP 30

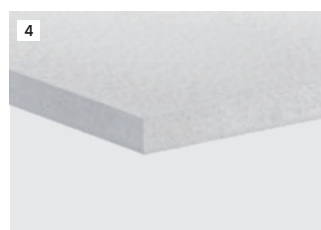
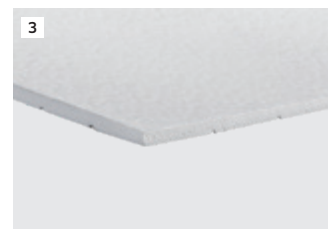
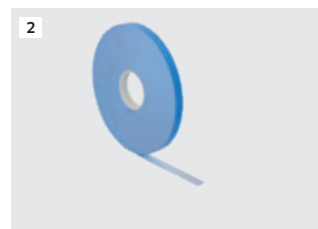
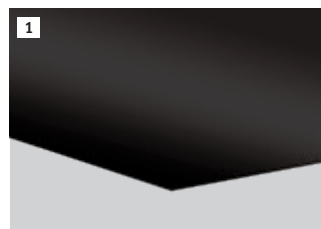

## ACCESSORIES FOR BLANKE PERMATOP BF, BF+ AND BFC

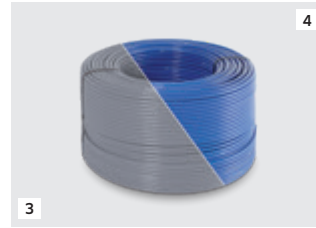
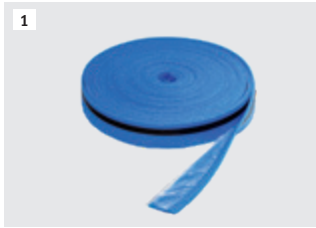

- 1 BLANKE RDS 10/120
- 2 BLANKE RDS 10/120 SK
- 3 BLANKE PIPE 14
- 4 BLANKE PIPE 16
- 5 BLANKE  
COMPRESSION FITTING 14
- 6 BLANKE  
COMPRESSION FITTING 16
- 7 BLANKE PIPE CLIPS
- 8 BLANKE BENDS
- 9 BLANKE COUPLING
- 10 BLANKE SCREED TEST POINT
- 11 BLANKE CONNECTION ELEMENT
- 12 BLANKE DOOR ELEMENT

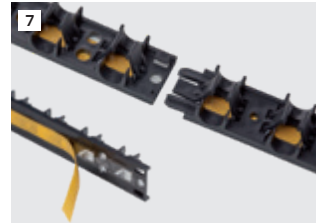

The BLANKE CONNECTION ELEMENT is used to easily and reliably connect studded panels in the BLANKE BASE range and to reduce waste.



The BLANKE DOOR ELEMENT is ideal for use around doorways.



## BLANKE PERMATOP 1000/3000/ECO

The innovative underfloor heating and cooling systems

All systems from the BLANKE PERMATOP series can be perfectly combined with Blanke's control system and smart home solutions.

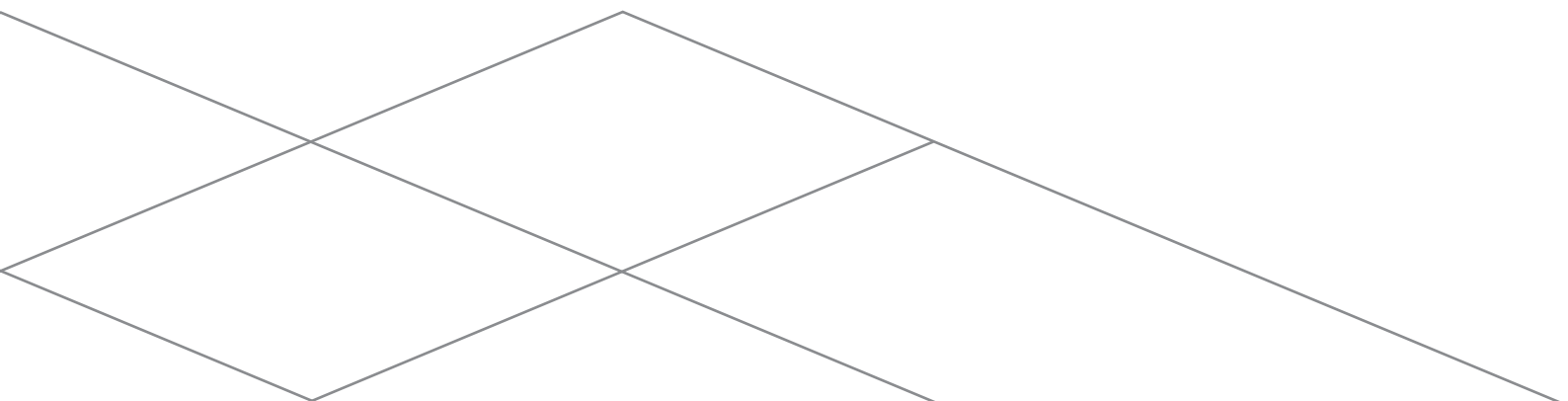

## BLANKE PERMATOP 1000



### ADVANTAGES AT A GLANCE

- > Extremely fast reacting surface heating and cooling system – noticeable warmth in just a couple of minutes
- > Low installation height - 35 mm
- > Saves more than 4 weeks of installation time because there is no need for screed
- > Particularly suitable for renovations

BLANKE PERMATOP 1000 is an innovative dry lining surface heating and cooling system. It combines the advantages of an EPS-based installation panel and heat diffusion panel mounted ex works with the high pressure stability of the BLANKE PERMAT underlayment and decoupling mat as a load-distributing layer. The heat diffusion panel, which is bonded across the entire surface area including in the deflection area, guarantees uniform and extremely fast heat distribution. The low weight per unit area of just under 11 kg/m<sup>2</sup> allows the use of a water-based surface area heating system, in particular for renovations, in wooden buildings or on storeys with wooden beam ceilings. Combined with the Blanke GLUEMAX special, fast-curing dispersion adhesive, Blanke PERMAT replaces the conventional layer of screed. It is characterised by its high resistance to bending, outstanding adhesive bonding values and its tensile and compressive strength. It also creates a thin construction without having to forgo uniform and fast heat distribution. Two different pipe spacings (12.5 cm and 25.0 cm) are available.

### BLANKE PERMATOP 1000 COMPONENTS

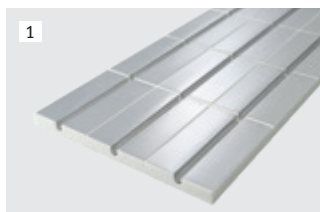

- 1 STRAIGHT PANEL
- 2 RETURN PANEL
- 3 COMPOSITE METAL PIPING  
16 X 2 mm
- 4 EDGE INSULATION STRIP
- 5 BLANKE GLUEMAX
- 6 BLANKE PERMAT



## BLANKE PERMATOP 3000



### ADVANTAGES AT A GLANCE

- > Extremely fast reacting surface heating and cooling system - noticeable warmth in just a couple of minutes
- > Low installation height - 31 mm
- > Saves more than 4 weeks of installation time because there is no need for screed
- > Particularly suitable for renovations

The BLANKE PERMATOP 3000 surface heating and cooling system is an advanced development of the BLANKE PERMATOP 1000 system (page 15) offering the corresponding advantages. The system panel made of Neopor (WLS 032) used here is characterised by its height of 31 mm and is always used where the installation height is limited. Two different pipe spacings (12.5 cm and 25.0 cm) are available.

### BLANKE PERMATOP 3000 COMPONENTS

- 1 STRAIGHT PANEL
- 2 RETURN PANEL
- 3 COMPOSITE METAL PIPING  
16 X 2 mm
- 4 EDGE INSULATION STRIP
- 5 BLANKE GUEMAX
- 6 BLANKE PERMAT

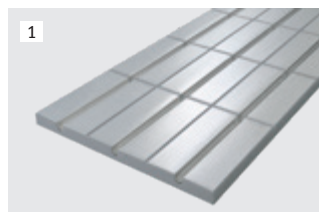



## BLANKE PERMATOP ECO



### ADVANTAGES AT A GLANCE

- > Extremely fast reacting surface heating and cooling system – perceptible warmth in just a couple of minutes
- > Low installation height – especially thin 35 mm
- > The dry construction method means that no screed is used, resulting in significant savings of climate-damaging CO<sub>2</sub>
- > Ideal for energy generators such as heat pumps
- > Resource-saving production of the elements: thin-layer aluminium heat diffusion plates and return panels without heat diffusion plates
- > Efficient installation gap of 16.6 cm

BLANKE PERMATOP ECO is a resource-saving, dry lining floor heating system with an installation height of 35 mm with integrated thermal insulation and decoupling. The system consists of EPS-based system panels with a factory-fitted aluminium heat diffusion plate and a high-quality composite metal pipe. The decisive factor in this floor heating system is efficiency – the pipe spacing of 16.6 cm is perfectly suited for use in combination with all regenerative heat generators. The use of raw materials is deliberately minimised here without detracting from the performance of the system. The dry construction method assures a quick installation and fast drying times.

### BLANKE PERMATOP ECO COMPONENTS

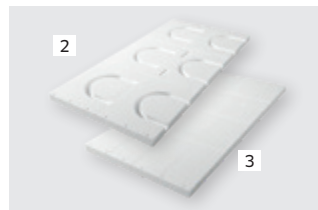
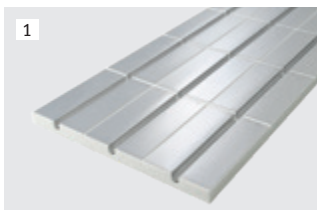

- 1 STRAIGHT ELEMENT IG 16.6 cm
- 2 RETURN PANEL IG 16.6 cm
- 3 CONSTRUCTION BOARD
- 4 COMPOSITE METAL PIPE  
16 X 2 mm
- 5 EDGE INSTALLATION STRIPS
- 6 BLANKE GUEMAX
- 7 BLANKE PERMAT



**Fast-reacting underfloor heating and cooling system**

The warmth is noticeable in just a couple of minutes thanks to the excellent heat distribution properties of the heat diffusion panel bonded across the entire surface area.

**Extremely low floor installation height, including insulation**

With the BLANKE PERMATOP 3000, the installation height is just 31 mm, which makes it particularly suitable for renovations.

**Saves more than 4 weeks building time**

Because installation requires no screed, because there are no drying times and costs to lay screed.

**Multifunctional**

BLANKE PERMAT makes it possible to lay all tile formats and all types of flooring.

**Low weight per unit area**

Especially suitable for renovations, in wooden buildings and with wooden beam ceilings



**UNIFORM HEAT DISTRIBUTION THANKS TO THE HEAT DIFFUSION PANEL**

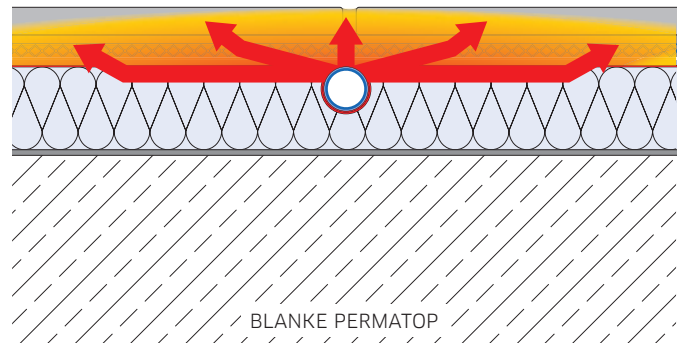
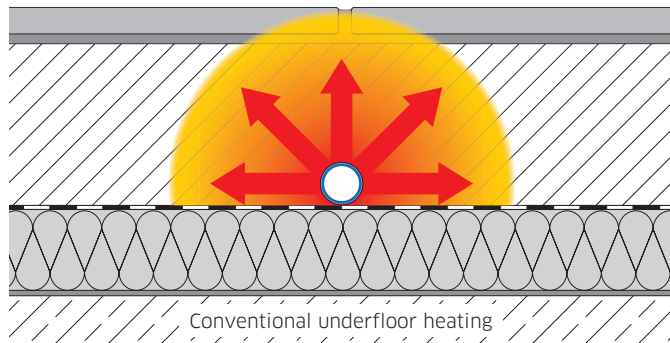

**■ Cross-section of conventional underfloor heating**  
Installation height from approx. 85 mm

**■ Cross-section BLANKE PERMATOP 3000 or 1000**  
Installation height 31 (3000) or 35 mm (1000)

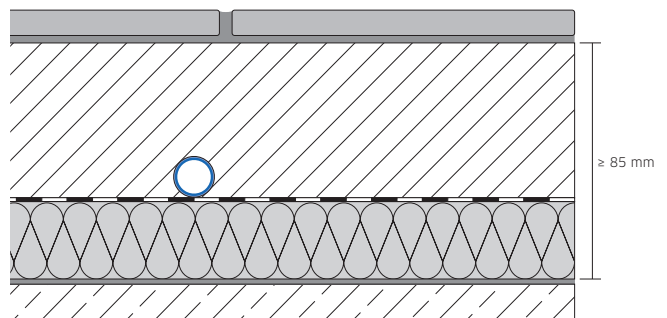
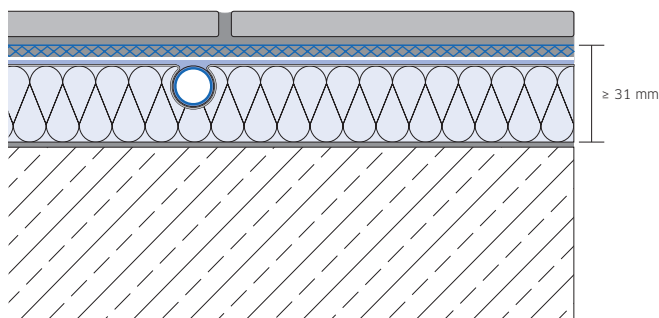

**■ Cross-section BLANKE PERMATOP 3000 or 1000**  
Installation height 31 (3000) or 35 mm (1000)

**■ Cross-section of conventional underfloor heating**  
Installation height from approx. 85 mm

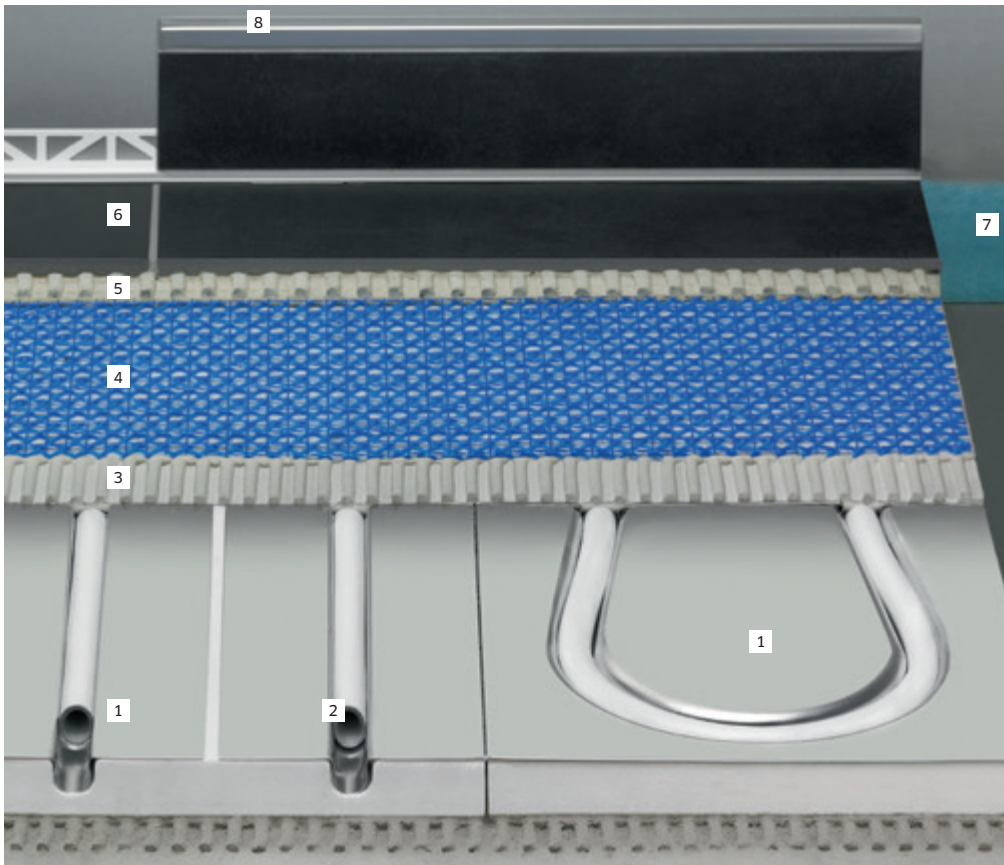

Standard system components  
(included in the price of BLANKE PER-  
MATOP 1000, 3000, WOOD and WALL):

- 1 BLANKE PERMATOP  
grooved/return panel
- 2 BLANKE PERMATOP  
composite metal pipe 16x2 mm
- 3 BLANKE GLUEMAX -  
special fast curing dispersion  
adhesive
- 4 BLANKE PERMAT -  
underlayment and decoupling mat  
Special dispersion adhesive
- 5 Thin-bed mortar C2 S1
- 6 Floor surface covering
- 7 BLANKE PERMATOP EDGE INSULA-  
TION STRIPS
- 8 Optional: BLANKE  
EDGE PROTECTOR TRIM

**Optional system components:**

- > In addition to the basic system,  
maintenance-free edge and expansion  
joint profiles are also available (e.g.  
BLANKE FLOOREX
- > Wall, skirting and floor trims are  
available in different material and  
colour variants (e.g. BLANKE TRI-  
ANGULAR TILE TRIM and BLANKE  
QUARTER CIRCLE TILE TRIM



Reg.-Nr. 7F435-F





## BLANKE PERMATOP WOOD/NATURE

Ecological underfloor heating and cooling systems

All systems from the BLANKE PERMATOP series can be perfectly combined with Blanke's control system and smart home solutions.

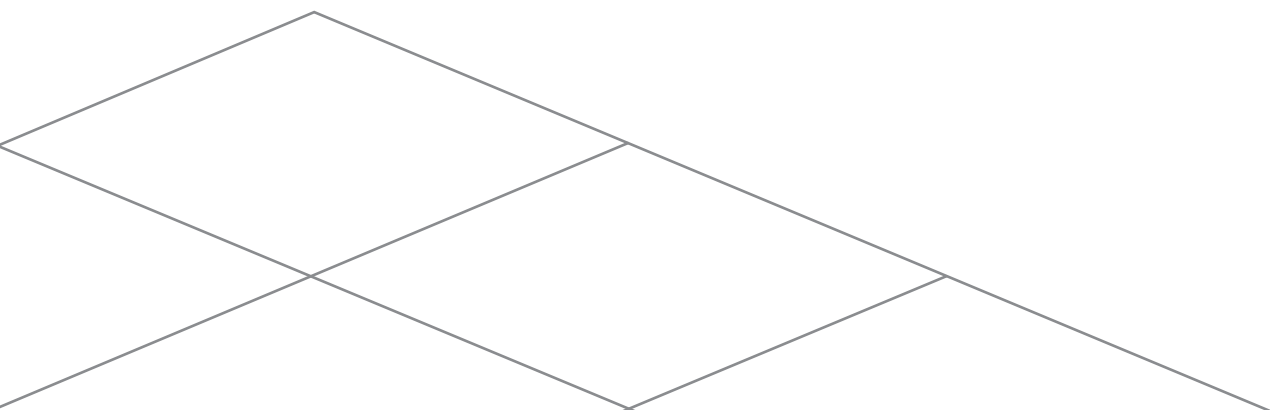

## BLANKE PERMATOP WOOD



### ADVANTAGES AT A GLANCE

- > Extremely fast reacting surface heating and cooling system - noticeable warmth in just a couple of minutes
- > Low installation height - 35 mm
- > Saves more than 4 weeks of installation time because there is no need for screed
- > Particularly suitable for renovations

The BLANKE PERMATOP WOOD surface heating and cooling system is a sustainable advanced development of the BLANKE PERMATOP 1000. The system is based on individual heating elements made of an aluminium heat diffusion panel mounted ex works and wood fibre insulation boards (WLS 050) with an installation height of 35 mm and a weight of 5.5 kg per m<sup>2</sup>. Two different pipe spacings (12.5 cm and 25.0 cm) are available.



Protecting the climate is not a matter of theory. There are many ways for sustainably protecting the climate and creating a liveable future by taking simple measures. A both energetically sensible and pleasant solution is available with BLANKE PERMATOP WOOD, the sustainable and ecological version with wood fibre insulation board from the PERMATOP family.

### BLANKE PERMATOP WOOD COMPONENTS

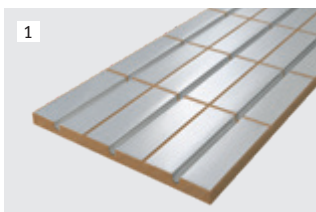

1

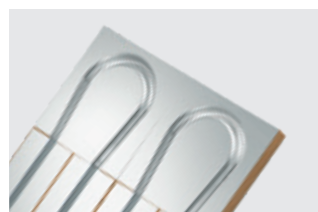

3

- 1 STRAIGHT PANEL
- 2 RETURN PANEL
- 3 COMPOSITE METAL PIPING  
16 X 2 mm
- 4 EDGE INSULATION STRIP
- 5 BLANKE GUEMAX
- 6 BLANKE PERMAT



4



5



6

## BLANKE PERMATOP NATURE

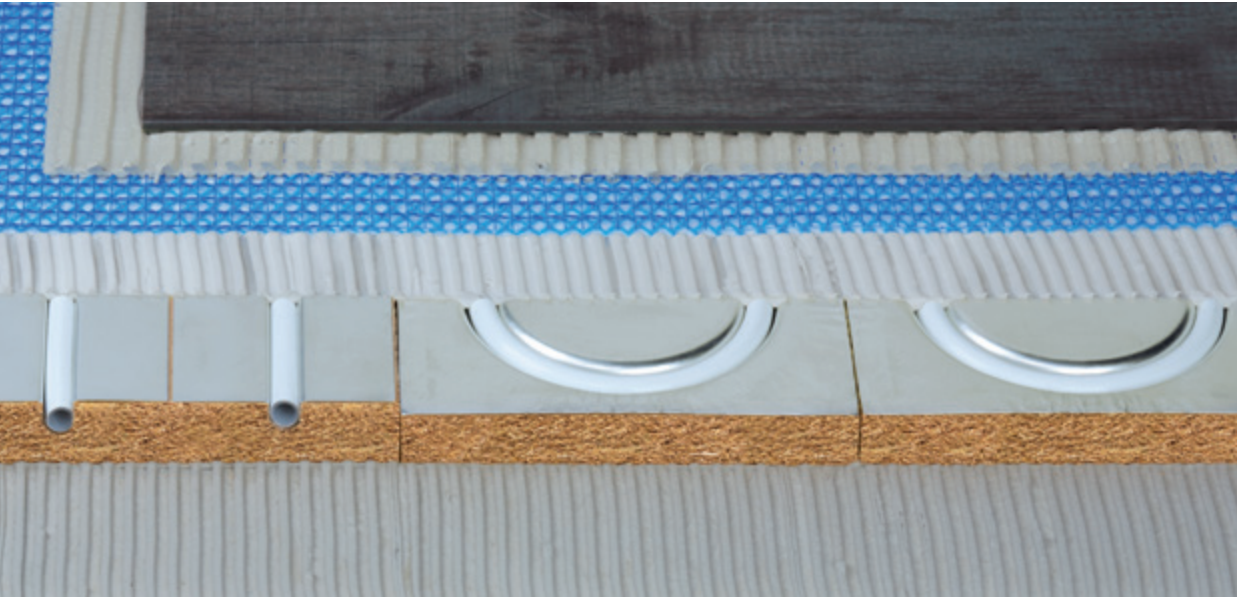

---

### ADVANTAGES AT A GLANCE

---

- > Convenient and energy-efficient due to fast control response
- > System panel made from renewable raw materials
- > Solutions for new construction & renovation projects with low installation heights
- > Dry installation for short construction times
- > CO<sub>2</sub> savings because no screed and therefore no cement are needed

BLANKE PERMATOP NATURE is a water-based, ecological surface heating and cooling system with straw panels. Straw is a readily available material and is particularly eco-friendly.

The system panel with a factory-fitted aluminium heat diffusion plate comes complete with a high-quality composite metal pipe and is available for installation gaps of 12.5 cm and 25 cm. With an installation height of 35 mm including integrated decoupling, this dry lining system is ideally suited for new construction & renovation projects. The dry lining method assures a quick installation and fast drying times. In addition there is no need for screed, which reduces the CO<sub>2</sub> foot print of the building considerably.

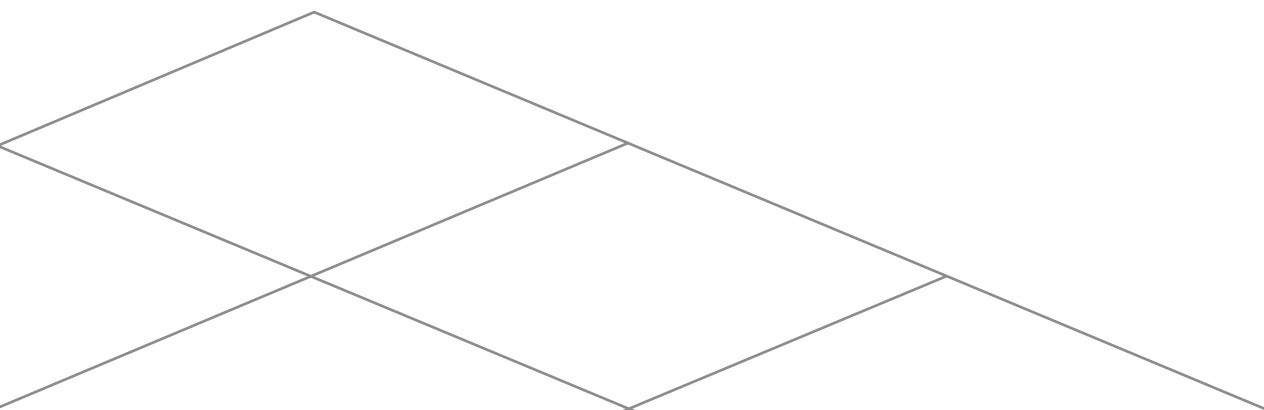

BLANKE PERMATOP NATURE COMPONENTS

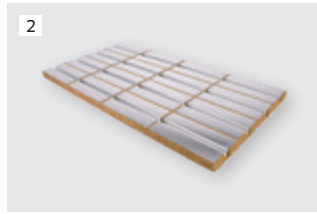
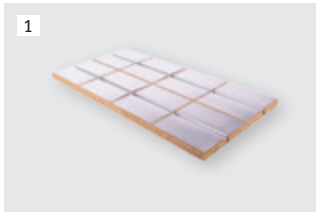

- 1 STRAIGHT ELEMENT IG 25 cm
- 2 STRAIGHT ELEMENT IG 12.5 cm
- 3 RETURN PANEL IG 25 CM
- 4 RETURN PANEL IG 12.5 cm
- 5 CONSTRUCTION BOARD
- 6 EDGE INSULATION STRIPS
- 7 COMPOSITE METAL PIPE  
16 X 2 mm
- 8 BLANKE GUEMAX
- 9 BLANKE PERMAT

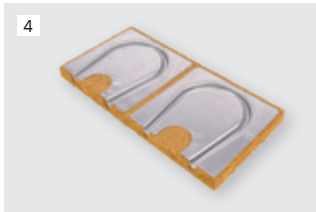

Omega shape of the pipe channels



Full-surface heat diffusion plates

Note:

Easy and quick installation due to the special product features of the single elements.

SUSTAINABLE.  
SAVES RESOURCES.

Straw as a system component? Naturally! The material offers outstanding characteristics. The quickly renewable raw material is also available from regional farms. This means there are no restrictions in other areas, such as competition with food products. Straw also offers maximum sustainability due to its separability and recyclability. As a system panel of a surface heating/cooling system, the material contributes to providing the greatest possible comfort.





## BLANKE PERMATOP WALL

Surface heating and cooling system for walls

All systems from the BLANKE PERMATOP series can be perfectly combined with Blanke's control system and smart home solutions.





## BLANKE PERMATOP WALL

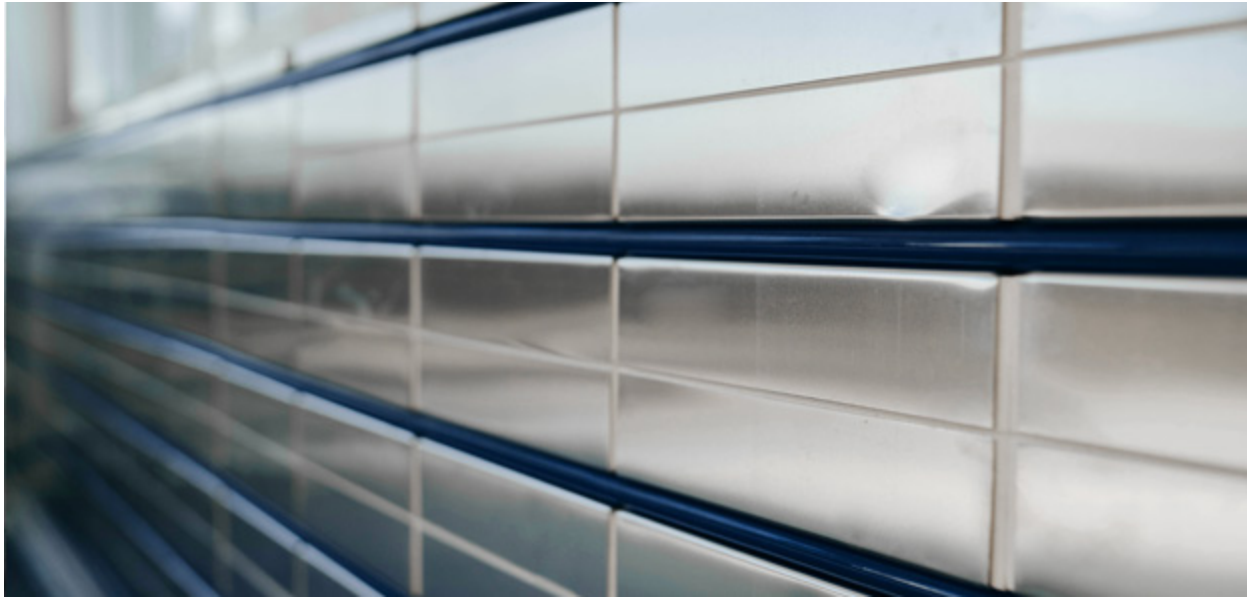

### ADVANTAGES AT A GLANCE

- > Very fast-reacting heating and cooling system for walls
- > Minimum layer height thanks to low thickness of 35 mm
- > Combines perfectly with all underfloor heating and cooling systems from the PERMATOP series

BLANKE PERMATOP WALL is a heating and cooling system for walls that facilitates short installation times and impresses with top performance figures. The temperature of the heating or cooling agent is only slightly above or below that of the ambient air. The greater portion of energy is emitted as radiation, which significantly increases the perceived sense of comfort. This system combines perfectly with all other solutions available in the range of Blanke surface heating and cooling systems.

### BLANKE PERMATOP WALL COMPONENTS

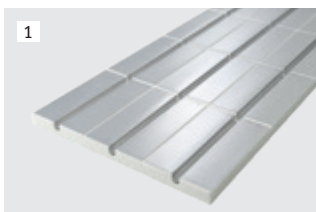

1



2

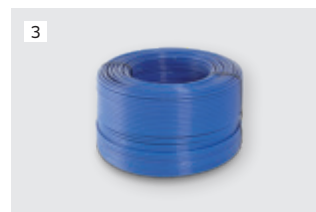

3



4



5



6

- 1 STRAIGHT PANEL
- 2 RETURN PANEL
- 3 BLANKE PIPE 16
- 4 EDGE INSULATION STRIP
- 5 BLANKE GUEMAX
- 6 BLANKE PERMAT

# ACCESSORIES AND TOOLS

To be able to supply you with everything from A to Z from a single source, Blanke also offers the suitable compression fittings, compression connectors and couplings for controlling the surface heating and cooling systems.

The systems can be installed easily and safely with the appropriate tools.

## ADVANTAGES AT A GLANCE

- > Tested and perfectly matching supplementary products
- > DIN CERTCO approvals for all system components
- > Safe installation

## BLANKE PERMATOP SF COMPONENTS

- 1 Blanke SF BASE
- 2 BLANKE RDS 5/50
- 3 BLANKE SF KLETT-TEC
- 4 BLANKE BENDS 10
- 5 BLANKE SF FILLER
- 6 BLANKE PERMAT
- 7 BLANKE SF COMPRESSION FITTING
- 8 BLANKE COUPLING

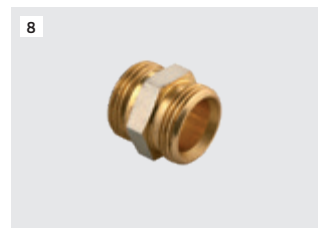
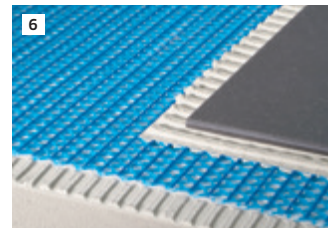
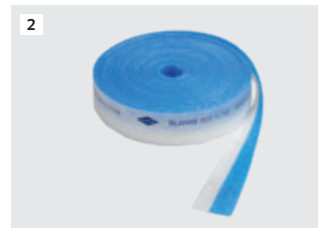
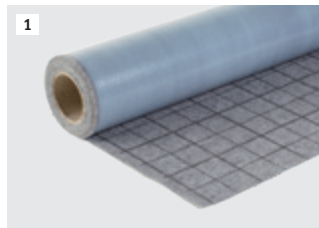

## ACCESSORIES FOR BLANKE PERMATOP 1000, 3000, ECO, NATURE AND WOOD

- 1 BLANKE COMPRESSION FITTING
- 2 BLANKE COMPRESSION CONNECTOR
- 3 BLANKE ELBOW ADAPTER 90°  
Nipple version
- 4 BLANKE ELBOW ADAPTER STRAIGHT  
Nipple version
- 5 BLANKE ELBOW ADAPTER 90°  
Socket version
- 6 BLANKE ELBOW ADAPTER STRAIGHT  
Socket version



## ACCESSORIES FOR BLANKE PERMATOP BF, BF+ AND BFC

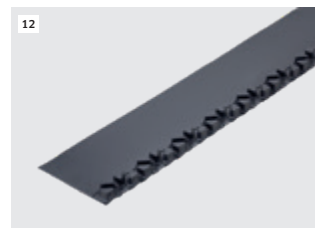
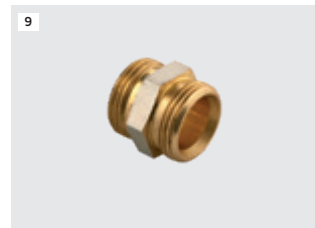
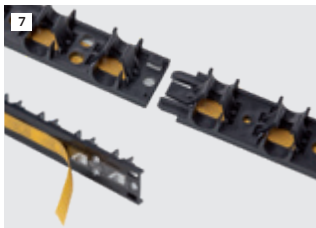
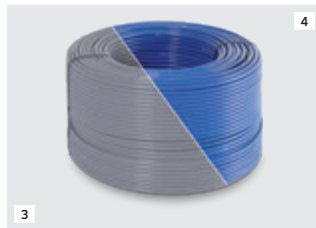

- 1 BLANKE RDS 10/120
- 2 BLANKE RDS 10/120 SK
- 3 BLANKE PIPE 14
- 4 BLANKE PIPE 16
- 5 BLANKE COMPRESSION FITTING 14 (14 mm x 3/4" Eurocone)
- 6 BLANKE COMPRESSION FITTING 16 (16 mm x 3/4" Eurocone)
- 7 BLANKE PIPE CLIPS
- 8 BLANKE PIPE BENDS
- 9 BLANKE COUPLING
- 10 BLANKE SCREED TEST POINT
- 11 BLANKE CONNECTION ELEMENT
- 12 BLANKE DOOR ELEMENT

## TOOLS - SURFACE HEATING AND COOLING SYSTEMS



We recommend using suitable tools for the simple and safe installation of BLANKE PERMATOP 1000, 3000, WOOD and WALL.

- 1 BLANKE Uncoiler
- 2 BLANKE EPS groove cutter
- 3 BLANKE Replacement blade for BLANKE EPS groove cutter
- 4 BLANKE Pipe shears
- 5 BLANKE Pipe beveling tool



# BLANKE HEATING CIRCUIT MANIFOLDS AND CONTROL TECHNOLOGY

and accessories

## BLANKE VARIO HEATING CIRCUIT MANIFOLD

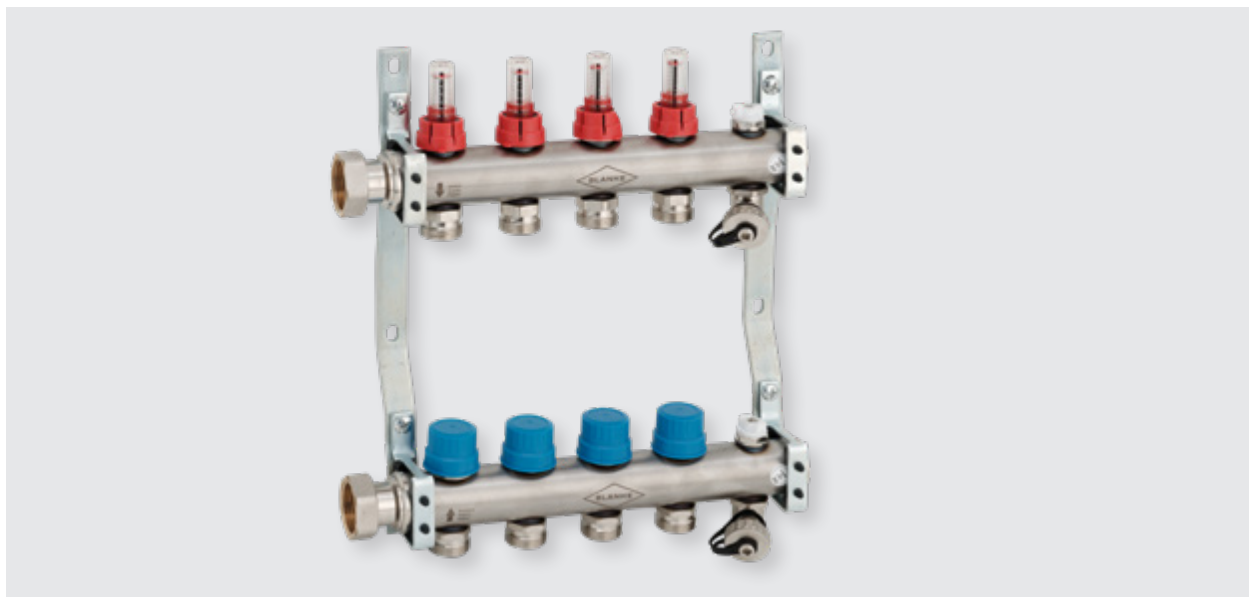

---

### ADVANTAGES AT A GLANCE

---

- > Stainless steel design for corrosion resistance
- > Optimised pump performance due to low pressure loss
- > Rugged, robust valve technology in case of adverse heating water quality
- > Flow rate display for precisely pre-setting the volumetric flow rates for each heating circuit
- > Preassembled version
- > Modular expandability

The BLANKE VARIO HEATING CIRCUIT MANIFOLD made of high-quality stainless steel is already preassembled. If required, heating circuits can also be subsequently installed using the extension set. The proven valve technology and additional flow rate indicators provide for ideal control capability. When coordinated with BLANKE SMART HOME products, the hydraulic calibration can be performed independently and fully automatically. The combination of the BLANKE VARIO HEATING CIRCUIT MANIFOLD and smart home control technology is eligible for subsidies in accordance with BAFA guidelines and has been certified by TÜV Rheinland.

## BLANKE HEATING CIRCUIT MANIFOLD AND ACCESSORIES

- 1 BLANKE VARIO HEATING CIRCUIT MANIFOLD
- 2 VARIO HEATING CIRCUIT MANIFOLD EXTENSION SET
- 3 BLANKE MANIFOLD SHUT-OFF, SUPPLY (RED)
- 4 BLANKE MANIFOLD SHUT-OFF, RETURN FLOW (BLUE)
- 5 BLANKE CONNECTION SET ELBOW (PWZ)
- 6 BLANKE CONNECTION SET STRAIGHT (PWZ)
- 7 BLANKE FIXED-VALUE CONTROL STATION with high-efficiency pump
- 8 BLANKE FIXED-VALUE CONTROL STATION with high-efficiency pump and heat exchanger

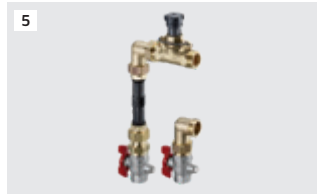
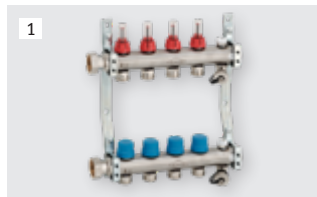

## ACCESSORIES FOR ALL BLANKE PERMATOP SYSTEMS

- 9 BLANKE ZONE VALVE
- 10 BLANKE DEAERATOR
- 11 BLANKE MICRO ABD
- 12 BLANKE THERMAL INSULATION SHELLS
- 13 BLANKE RETURN FLOW TEMPERATURE LIMITER VALVE
- 14 BLANKE UNIVERSAL COVER
- 15 BLANKE DESIGN RETURN TEMPERATURE LIMITER VALVE BLACK with a black glass cover
- 16 BLANKE DESIGN RETURN TEMPERATURE LIMITER VALVE WHITE with a white glass cover
- 17 BLANKE MIXING UNIT
- 18 BLANKE Y-JUNCTION CONNECTOR
- 19 BLANKE ADAPTER FITTING
- 20 BLANKE MULTIBLOCK SET CHROME
- 21 BLANKE MULTIBLOCK SET WHITE
- 22 BLANKE INSTALLATION BLOCK FOR MULTIBLOCK SET
- 23 BLANKE INSTALLATION AID FOR MULTIBLOCK SET

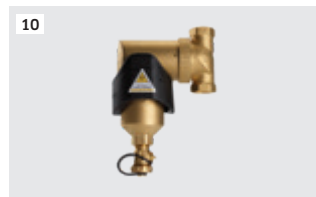

### Important note:

BLANKE Y-JUNCTION CONNECTORS are only suitable for connection to the BLANKE MIXING UNIT and to BLANKE HEATING CIRCUIT MANIFOLDS.

## MANIFOLD CABINETS AND ACCESSORIES FOR BLANKE PERMATOP SYSTEMS



- 24 BLANKE FLUSH-MOUNTED  
MANIFOLD CABINET
- 25 BLANKE SURFACE-MOUNTED  
MANIFOLD CABINET
- 26 BLANKE TURN-LOCK FASTENER



## BLANKE CONTROL 230



### ADVANTAGES AT A GLANCE

- > No regular maintenance required due to continuous power supply maintenance required
- > Perfect for public facilities and similar buildings buildings thanks to timer program

The basic prerequisite for an ideally functioning surface temperature control is a demand-oriented, energy-saving individual room controller with high control accuracy, which adjusts the heating and cooling performance to perfectly suit the user's requirements. The BLANKE CONTROL 230 system is a wired individual room controller in a modern design. All the components of this classically wired individual room controller can be used both as stand-alone elements as well as in the overall system. Combining the controller and base versions into an individual room control system allows both simple as well as complex requirements for heating and cooling applications to be realized which leave nothing to be desired.

### BLANKE CONTROL 230 COMPONENTS

- 1 BASE UNIT 230  
6-/10-fold
- 2 ROOM CONTROL DEVICE  
230, WHITE
- 3 ROOM CONTROL DEVICE  
230, BLACK
- 4 ROOM CONTROL DEVICE  
230, WHITE with clock  
and sensor connection
- 5 ROOM CONTROL DEVICE  
230, BLACK with clock  
and sensor connection







## BLANKE ON SOCIAL MEDIA

On our social media channels we post the latest news about Blanke, our projects and visions for the future. Follow us on our different channels and discover input about our company, new products, carrier opportunities and events - or just gather inspiration from the pictures of our projects.

Find us on one of the below mentioned platforms.



[www.instagram.com/blanke\\_systems/](https://www.instagram.com/blanke_systems/)



[www.youtube.com/c/BlankeSystemsIserlohn/videos](https://www.youtube.com/c/BlankeSystemsIserlohn/videos)



[www.pinterest.de/BlankeSystems/](https://www.pinterest.de/BlankeSystems/)



Consultation and sales:

**Blanke Systems GmbH & Co. KG**  
Stenglingser Weg 68-70  
58642 Iserlohn / Germany  
T +49 (0)2374 507-0  
E [info@blanke-systems.de](mailto:info@blanke-systems.de)  
I [www.blanke-systems.com](http://www.blanke-systems.com)

