

BLANKE PERMAT

BLANKE PERMAT protects tiles and natural stone finishes, saving time and money. For use as a reinforcing underlayment for tile and stone it acts as a decoupling membrane in industrial and private environments on all substrates – from new and old screeds to wood floors – and also combinable with a wide variety of tile formats. Thanks to the glass fibre mesh and multi-layer structure the system boasts high adhesive bonding values as well as resistance to bending, tensile and compressive loads. This allows floorings to be laid earlier, as any deflections in shape are not transferred to the upper floor covering; in addition, it is the key product for the floor systems BLANKE PERMATOP and BLANKE PERMATFLOOR.

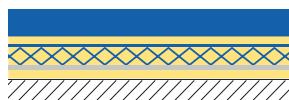

BLANKE PERMAT

30 panels in a carton
Dimensions: 97 x 62 cm

PU: 1 carton

	Art. no.	€/m ²
1 carton = 18 m ²	527-904	21.05
1 pallet (11 cartons) = 198 m ²	527-904	20.01
1 pallet (334 x individual panels) = 200 m ²	527-904-PAL	20.01

Important note:

Including test report

tBU Greven (test institute)

Suitable for:

- > Dry screeds
- > Old screed/old substrates with cracks
- > All types of wood floors
- > On top of old tiles with cracks
- > New screed, to prevent cupping
- > Underfloor heating

More than 10 years of peace of mind:

The innovative, reinforcing underlayment for tile and stone and decoupling mat BLANKE PERMAT offers more than 10 years of reliability for tiles.

